

Zip HydroTap® All-In-One Commercial Models (Vented Mixer Tap)

Boiling and chilled filtered drinking water, instantly,
PLUS hot, cold or mixed warm water – All from the one tap!

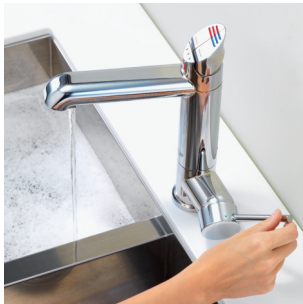

Instant boiling and chilled filtered water



PLUS hot, cold or warm



Simplifies kitchen design



Features

- Replaces mixer taps to de-clutter and simplify kitchen design.
- Saves space, cost and energy by eliminating the need for a separate hot water supply.
- Top mounted drinking water controls for convenience and safety.
- Press the red (boiling) or blue (chilled) levers to fill cups or glasses.
- Pull levers forward for hands-free measured delivery into larger vessels.
- Safety lock, requiring finger-thumb operation, can be activated if required to control boiling water delivery.
- Additional electronic boiling water isolation safety feature also provided for “high risk” sites.
- Separate lower control lever to dispense hot, cold or mixed warm water.
- Superior energy saving features

Power-Pulse™ energy saving technology reduces power consumption by allowing the system to electronically regulate its power during high and low usage periods. This saves energy whilst maintaining the tightest possible temperature control.

Programmable 24/7 Timer

Pre-set the “power on” and “power off” times (once each day) for those periods when the HydroTap will not be used such as overnight or at weekends.

Inactivity Sleep Mode

The boiling system can be pre-set to power down after 2 hours of non-use but will still retain stored “boiling” water at an energy-saving 64°C. Typical system daily running costs less than 15p with sleep mode active for 10 hours.

Low light Sleep Mode

An integral light detector can be set to automatically activate sleep mode (as above) when room lights are switched off, returning to normal operation when the lighting is switched back on.

Hibernation Mode

When activated allows the entire system to totally power down after 2 hours of non-use.

Easy reactivation from all four of these modes by pressing the boiling or chilled levers.

Superior sub-micron filtration ensures crystal clear, great tasting, healthier water.

- 1) Removes suspended impurities smaller than one thousandth of a millimetre.
- 2) Removes chlorine plus other tastes and odours.



Zip Product Specification Sheet



Zip HydroTap® All-In-One Commercial Models (Vented Mixer Tap)

Product Selection Chart

Zip Model	Boiling Water	Chilled Water	Hot Water	Cold Water	Boiling Cups/hr	Chilled Glasses/hr	Total Rating	Under-Sink W x D x H
BC200/175+AV	✓	✓	✓	✓	200	175	2.8 kW	500 x 465 x 395
BC150/175AV	✓	✓	✓	✓	150	175	2.1 kW	500 x 465 x 395
BC160/125+AV	✓	✓	✓	✓	160	125	2.3 kW	440 x 430 x 337
BC100/125AV	✓	✓	✓	✓	100	125	1.7 kW	440 x 430 x 337

+ Signifies models are Free-Flow. The 'free-flow' models ensure cold filtered water continues to flow even during periods of high usage when the 'chilled glasses per hour' capacity is exceeded.

Technical Features

- Open outlet boiling system delivers:
 - Boiling water factory set at 98°C and adjustable from 68°C – 99°C.
 - Chilled water factory set to deliver between 5°C – 10°C.
- Mixes boiling and cold water to create hot water at approximately 50°C (no hot water service connection required).
- Fan cooled condenser chilling system using R134A refrigerant.
- Long life stainless steel tanks.
- Long reach tap spout swings 120° for convenience.
- Tap LEDs indicate system status, temperature and need for filter replacement.
- Base unit display aids set up and provides detailed system information.

with a minimum pressure of 0.7 bar. If pressure exceeds 7 bar a pressure limiting valve must be fitted. The under sink system must be located within 1 metre of the tap. Under sink connection tubing to the tap must be taut for proper drainage and never be looped or coiled. An isolating valve should be installed between the mains supply and the system.

Electrical

Should be installed by a competent person in accordance with the fitting instructions supplied and UK Electrical Regulations. System should be connected to a convenient 13A fused spur. Power supply 220V to 240V AC 50 Hz.

Filtration

Integral sub-micron filter easily accessible for replacement.

Note that use of this filter in locations with excessively high levels of sediment in the water supply may significantly reduce filter life. In such situations a 5 micron filter may be substituted.

In hard water areas where mineral scale accumulation is an issue consideration should be given to the maintenance required. We recommend the use of the Zip FL3000 scale filter system.

Ventilation

IMPORTANT. It is essential that the cupboard containing the undersink unit is adequately ventilated as poor circulation will adversely affect the performance of the HydroTap. Cupboard doors must be offset all round using the 4mm buffers provided.

The under-sink system must be installed with service access clearances of 50 mm left and right, 220 mm above and 65 mm rear. In addition the supplied vent should be fitted in the door or cupboard side wall to dissipate heat to the adjoining area. Where ventilation is limited, it is strongly recommended that the optional auxiliary fan REF: SP90651 is used – always use with BC150/175AV and BC200/175+AV (supplied as standard).

Accessories

- ZT002 – Sub-micron replacement filter
- ZT005 – 5 micron replacement filter
- FL3000 – Scale filter system
- FL3001 – Replacement scale filter cartridge
- SP90651 – Auxiliary fan

Warranty

12 Months on-site parts and labour warranty. For full warranty details please visit: www.zipheaters.co.uk

Technical Support

Contact Zip on Tel: 0800 077 8302

Service

Zip has the largest team of directly employed Engineers in the UK solely focused on boiling and chilled water products. It also offers a range of preventative maintenance plans providing on-site filter replacement, sanitisation, inspection and adjustment. Tel: 0800 077 8302

Installation Requirements

Location

The Zip HydroTap All-in-One Commercial System is designed to service one or two sinks. Requires a 50mm hole for tap installation.

Plumbing

Should be installed by a competent person in accordance with the fitting instructions supplied and UK Water Regulations. Water supply must be potable (drinkable)

HydroTap All-In-One Commercial Vented Mixer Tap

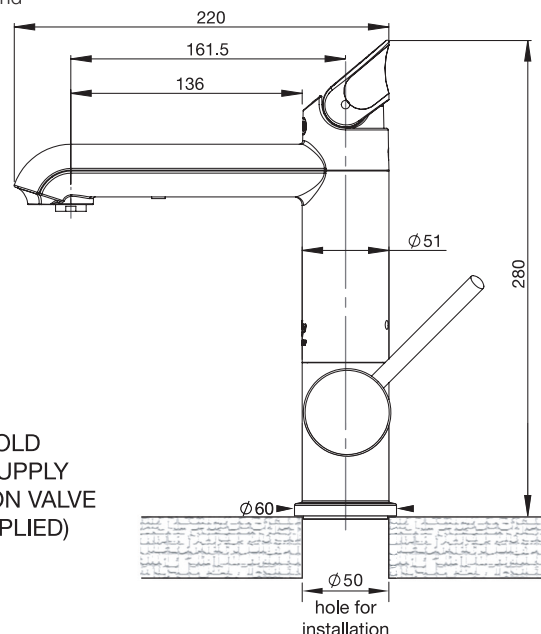
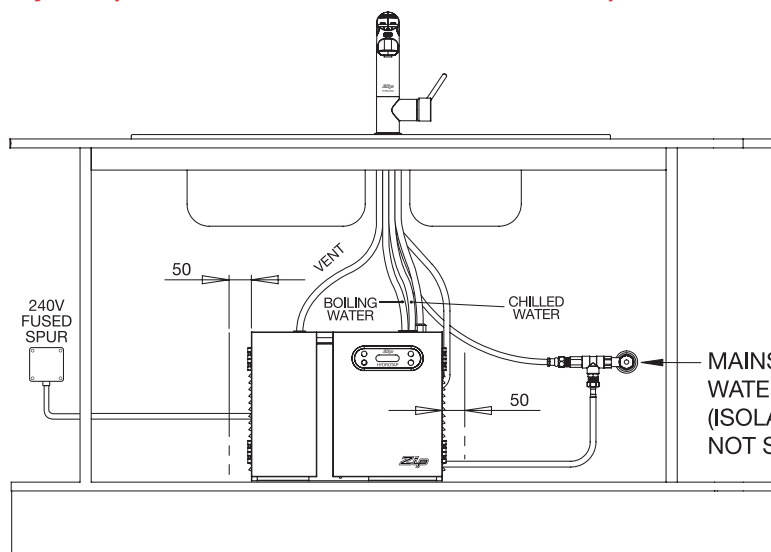

As Zip policy is one of continuous product improvement changes to specifications may be made without prior notice.

The terms, Zip, HydroTap and Power-Pulse are Trademarks

Data Sheet ZSSAIOV2 | UK February 2011