

Zip HydroTap[®]

Filtered boiling and chilled water for kitchens and tea rooms



73078 Zip HydroTap ABC10/30FXC
73119 Zip HydroTap ABC30/30FXC

73081 Zip HydroTap ABA10FXC
73123 Zip HydroTap ABA30FXC

73118 Zip HydroTap ABB10FXC
73121 Zip HydroTap ABB30FXC

73110 Zip HydroTap B10C
73111 Zip HydroTap B30C

Contents

Read These Warnings First	4
Models covered by these instructions	5
Installation Requirements	5
Special tools required	6
Installation procedure	6
Step A - Installing the tap (all models)	6
Step B - Installing the undersink unit (all models) ..	7
Step C - Connecting the tap	7
Installation with Tap Font	8
Tap Font Mounting Template	a-d
Installation procedure Continued	13
Step C - Connecting The Tap continued	13
Step D - Connecting the water supply (all models) ..	14
Step E - Testing and commissioning	14
Solving general problems	15
Operating the Tap	16
Cleaning	17
Replacing the Filter	17
Setting the Energy Saver Timer	18
Setting Correct Time	18
Programming Power ON & OFF	18
Warranty	19
Contact Details	20

Read These Warnings First



Safety

Do not allow young children, handicapped or infirm persons, to use the Zip HydroTap without supervision

Refrigerant

The Zip HydroTap Chilling unit contains 134A refrigerant under pressure. No part of the unit should be exposed to a naked flame. Maintenance of refrigeration unit must be carried out by an accredited service provider or qualified refrigeration mechanic.

Qualifications

If any power cord or plug is damaged it must be repaired only by a qualified technician.

To avoid hazards, all installation procedures must be carried out by a suitably qualified tradesperson.

Venting

Sometimes steam and/or boiling water may discharge through the vent at the rear of the tap shank. If the tap is not installed on a sink, the pipe to this outlet must be disconnected and plumbed away to a safe location according to local plumbing bylaws and regulations.

Lifting

Take care when lifting the Zip HydroTap undersink unit. Some units may exceed safe lifting limits. Do not lift without assistance. The weights of the units are given in the table under Installation Requirements (page 5).

Airflow

Proper air circulation must be provided. The system will operate satisfactorily only if the recommended air gaps are provided. If this is not possible, ventilation slots must be cut into the top AND bottom of the cupboard door. Make sure that the ventilation grilles of the undersink unit are not obstructed.

Altitude

At altitudes over 500 metres above sea level, the thermostat temperature may require adjustment. Contact your Zip Service Provider.

Filter

For models ABC, ABA and ABB only:

The Zip HydroTap filter timer is preset to nine months to provide trouble-free flow and operation in most installations. Local water quality conditions may require an alteration to this time. In areas where the water has a high concentration of sediment, the preset time may be shortened to avoid poor flow, taste or odour situations. In areas where the water quality is above average, lengthening the preset time may be desirable, but not essential.

If any of these changes are needed, contact your Zip Service Provider.

Models covered by these instructions

These Installation Instructions cover the entire Zip HydroTap range. Use the chart on the left to identify the model you are using:

ABC	10/	30	FX
Model	Boiling Water Capacity	Chilled Water Capacity	Filtration

Model:

ABC = Filtered, boiling and chilled, timer

ABA = Filtered, boiling and ambient

ABB = Filtered, boiling only

B = Boiling only (unfiltered)

Boiling Water Capacity:

10 = 10 cups 30 = 30 cups

Chilled Water Capacity: (ABC only)

30 = 30 cups

Filtration: (ABA, ABB and ABC only)

FX = Sub micron filter

Installation Requirements

Before installing ensure that the following have been provided at the installation site:

- Sufficient space in the cupboard to install the undersink unit in accordance with these Installation Instructions. A table of dimensions is given below.

Capacity 10/30	Height	Depth	Width	Weight kg/(lb)	
	mm (in.)	mm (in.)	mm (in.)	Empty	Full
ABC	340 (13.4)	510 (20)	340 (13.4)	30 (66.1)	36 (79.3)
ABA and ABB	343 (13.5)	343 (13.5)	287 (11.3)	14 (30.8)	16 (35.2)
B	340 (13.9)	277 (10.9)	194 (7.6)	12 (26.4)	14 (30.8)

Capacity 30/30	Height	Depth	Width	Weight kg/(lb)	
	mm (in.)	mm (in.)	mm (in.)	Empty	Full
ABC	383 (15)	510 (20)	477 (18.8)	32 (70.5)	42 (90.3)
ABA and ABB	383 (15)	433 (17)	340 (13.4)	18 (39.7)	23 (50.7)
B	380 (15)	369 (14.5)	284 (11.2)	16 (35.2)	21 (46.2)

- A water supply connection with isolating valve inside the cupboard within reach of the 750 mm flexible connection and positioned so that the connection point and the stop cock will not be obstructed when the undersink unit is installed.
- A water supply which can deliver 2 litres per minute flow rate at minimum of 1.5 Bar (150 kPa) flow (dynamic) pressure.
- Power supply connection to the heater via a double pole fused spur with a minimum break rating of 13 amps.
- Cold water supply with a minimum working pressure of 1.5 bar (150 kPa) and a maximum working pressure of 10 bar (1000 kPa) connected via an isolation valve.



Important:

Do not proceed with the installation if these requirements are not met.

Special tools required

In addition to normal tools, the following will be required:

- 13.5 mm diameter sheet metal hole punch
- 35 mm diameter sheet metal hole punch.

Installation procedure

Step A - Installing the tap (all models)

Locate the stick-on tap hole mounting template in the accessory envelope and apply to a flat surface at the left rear corner of the sink. Follow the instructions on the template.

Make sure that the tap will be able to drain into the sink.

Mark the two hole centres and cut the small hole using a 13.5 mm sheet metal hole punch

Cut the large hole using a 35-mm sheet metal hole punch.

Install the tap, making sure it is adequately sealed.

To ensure proper sealing, make sure that the tap mounting items are assembled in the order shown in the Assembly Detail diagram below. Ensure that the upper plate is properly inserted in the recess on the bottom of the sealing ring.

Tighten the fixing screws firmly.

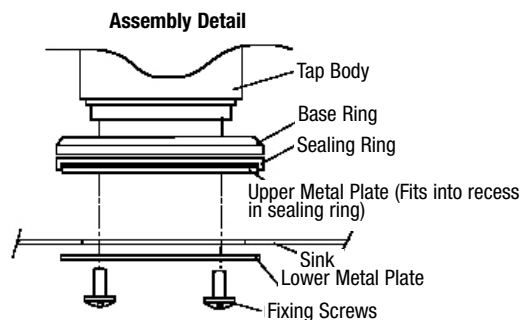
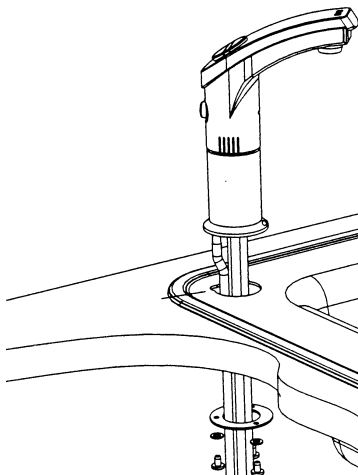
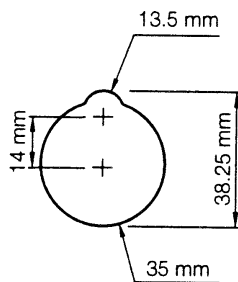
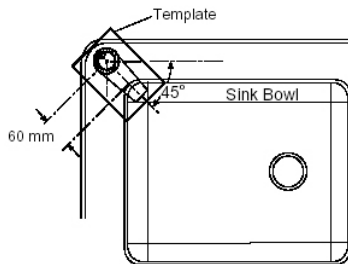

Installation with Tap Font

An alternative to mounting the Zip HydroTap tap head on a sink.

Use Zip HydroTap Tap-Font kit to install tap anywhere on bench.

To order Tap-Font kit, quote Zip part number 99057.

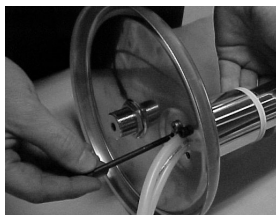
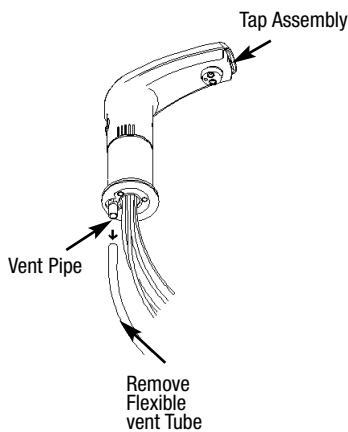
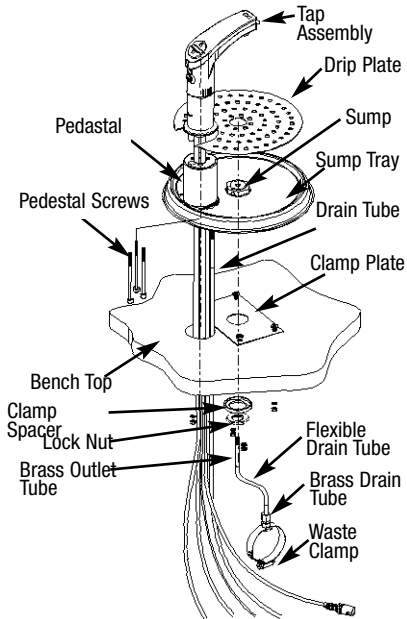

Inserting screw through pedestal to underside of tap.

Features

The sump built into the Tap-Font drains away to any nearby waste.

Also elevates tap outlet to provide 210 mm clearance for pots.

Positioning

Position Tap-Font as close as possible to directly above under-sink unit.

Never extend either the cable or tubing attached to the head assembly.

If possible position tray on bench so the tap is to the rear, then rotate base 45 degrees anti-clockwise.

Drilling

Use paper template to drill 57 mm hole, 45 mm hole and 4 screw holes.

For timber bench, drill 3 mm screw holes for timber screws provided.

For granite or similar, drill 6 mm holes for stainless screws provided.

Assembling

Fix clamp plate to bench top using 4 "timber" or "stainless" screws provided.

Remove silicon vent tube from base of tap assembly as shown in diagram.

Pass electrical cable, then tubes, from tap base through pedestal as shown.

Check cable and tubes to ensure all are free, none are twisted or kinked.

Fix the tap head assembly to pedestal using 3 pedestal screws.

Apply sealant to thread on brass tube supplied, screw into pedestal base.

Attach disconnected silicon vent tube to brass vent tube as shown in photo.

Apply a light bead of sealant to the underside edge of the sump tray.

Position the tray so the sump drain outlet lines up with the fixing plate hole.

Swivel tray so pedestal is positioned above largest hole in bench.

Pass all cables and tubes from pedestal through largest hole in bench.

Fit clamp spacer and lock nut on to drain bush and tighten securely.

Clean off any sealant squeezed out around sump tray during clamping.

Connecting

Install the waste clamp in an accessible position on the "sink side" of drain trap and as high as possible above the trap water line.

The waste clamp must never be installed on the "drain side" of drain trap.

To drill access hole into trap, remove nut and olive from clamp fitting and select drill bit to fit inside diameter of the clamp fitting hole.

Fasten clamp to drain pipe and drill access hole through hole in clamp.

Apply sealant to thread on brass tube supplied and fasten tube to clamp with nut and olive, referred to above.

Apply sealant to similar brass tube and fit to drain bush on sump.

Connect tube on clamp to tube on sump using flexible tubing provided.

Ensure flexible tube has a continuous fall from sump to clamp.

Remove protective coating from stainless steel, wipe clean and fit removable drip plate. Fit remaining tubes and cable as shown on page 7.

Detach this papertemplate and use it to position your Zip Hydrotap Tap-Font on your kitchen bench.

MINIMUM
CLEARANCE
FROM REAR
WALL.

80 mm

45 mm

SMALL HOLE

SCREW HOLE

CIRCUMFERENCE
OF TAP-FONT BASE

SCREW HOLE

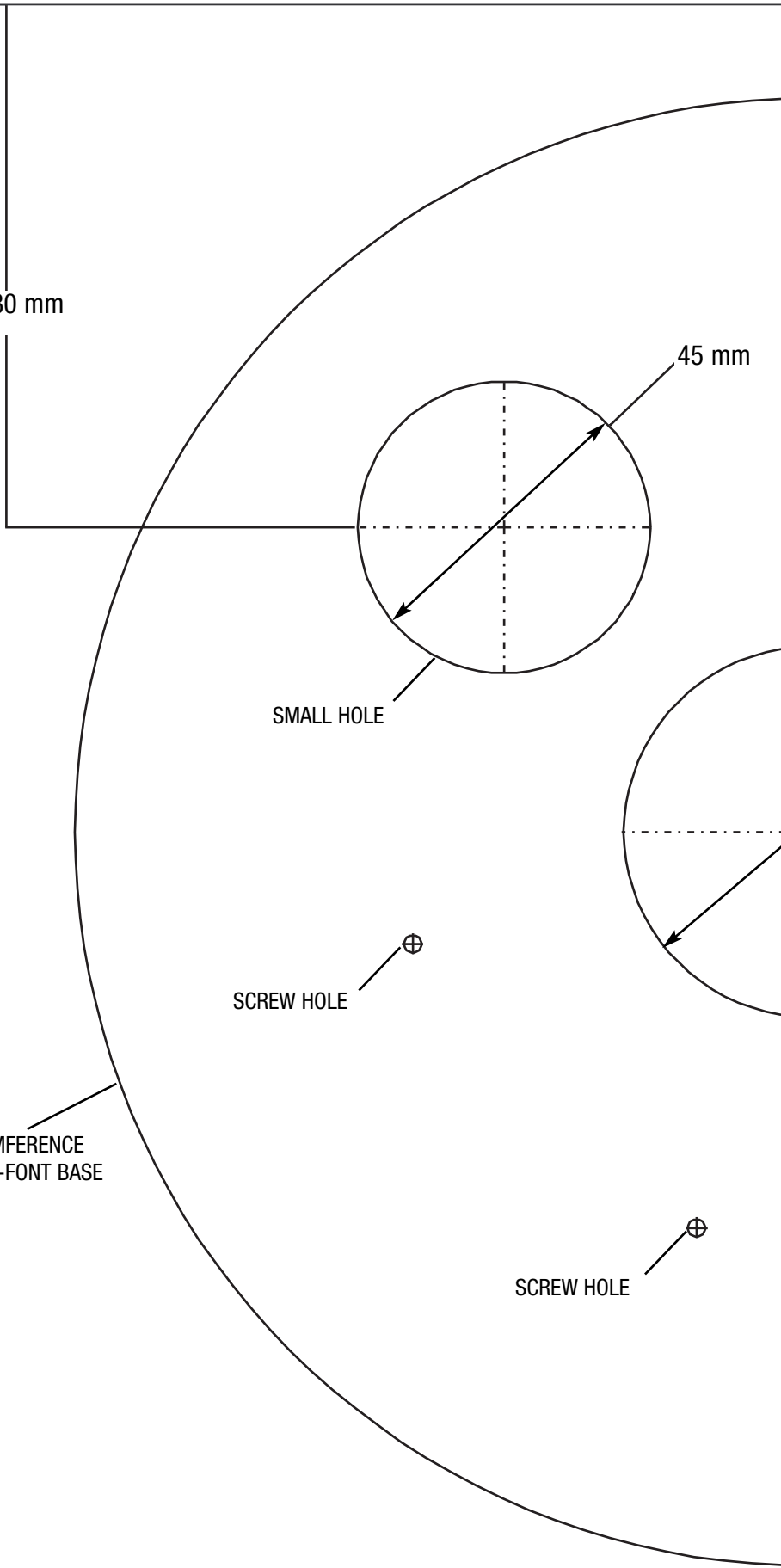

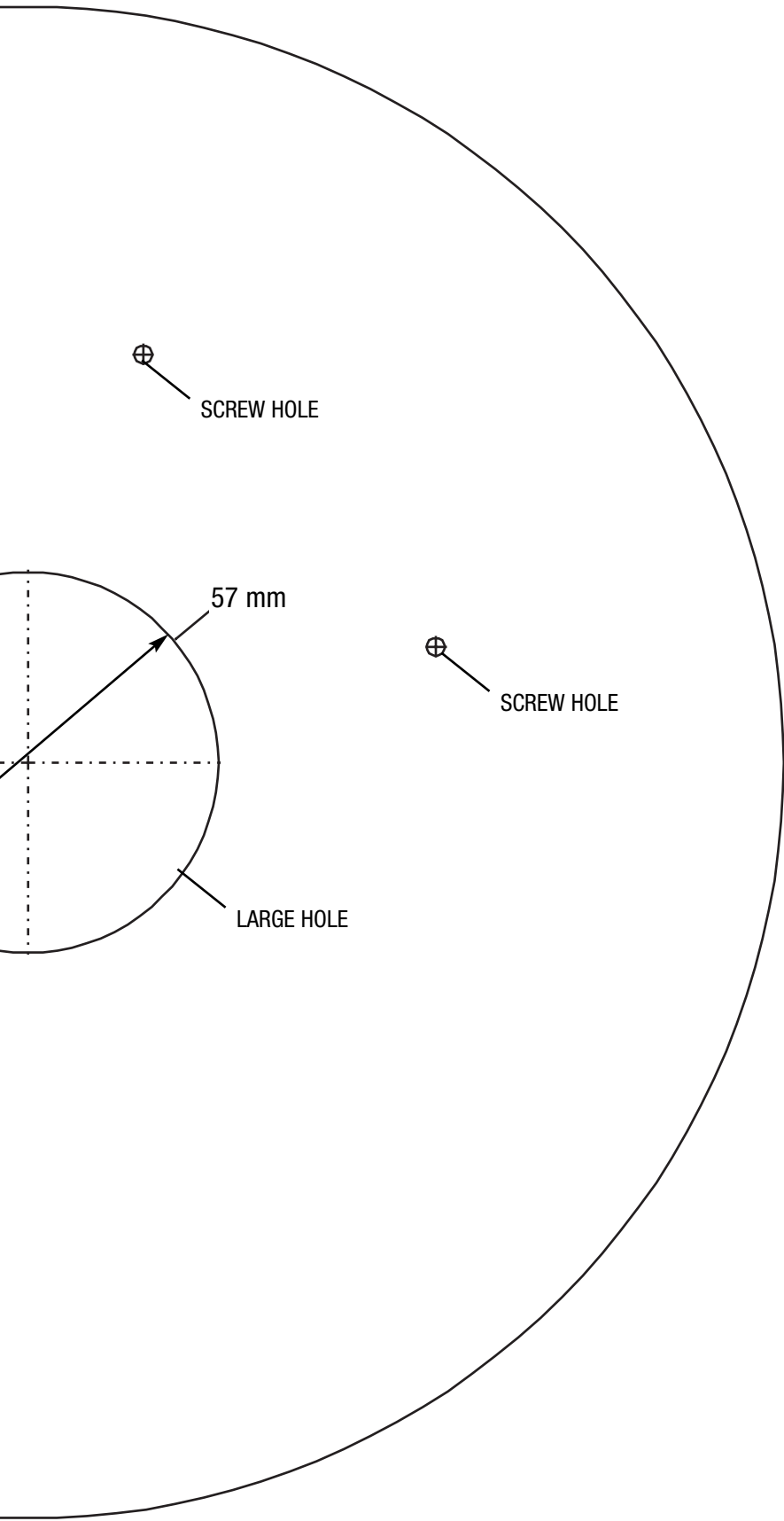

Detach this paper template and use it to position your Zip Hydrotap Tap-Font on your kitchen bench.

Installation procedure continued

Connecting the Tap continued

Models ABA and ABB

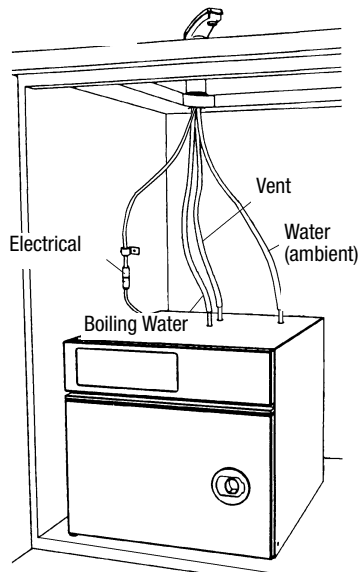

Measure and trim the red marked tube and connect it to the hot water outlet on the top of the undersink unit.

Measure and trim the unmarked tube and connect it to the vent outlet on the top of the undersink unit.

For ABA only, measure and trim the blue marked tube and connect to the ambient water outlet on the top of the undersink unit..

Connect the tap electrical connector to the cord attached to the undersink unit. Align the pins carefully and do not force the plug. Clamp the cable to the wall with clips provided so that the plug hangs vertically.

Model B

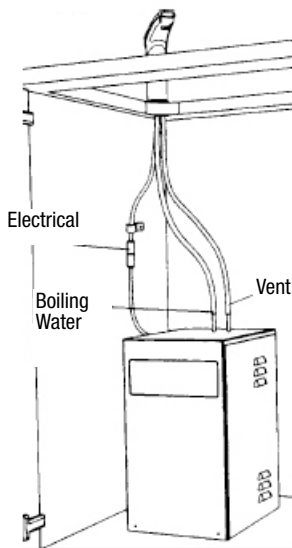

Measure and trim the red marked tube and connect it to the hot water outlet on the top of the undersink unit.

Measure and trim the unmarked tube and connect it to the vent outlet on the top of the undersink unit.

Connect the tap electrical connector to the cord attached to the undersink unit. Align the pins carefully and do not force the plug. Clamp the cable to the wall with clips provided so that the plug hangs vertically.

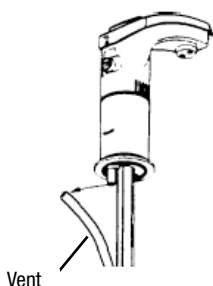

Note: In some circumstances, steam and/or boiling water may discharge from the vent at the rear of the tap shank. If the tap is not installed on a sink, the pipe to this vent must be removed from the spigot at the base of the tap and plumbed away to a safe location in accordance with local plumbing regulations

Installation procedure continued

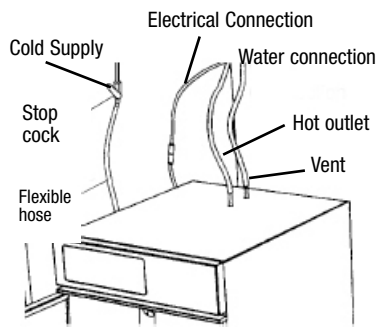

Step D - Connecting the water supply (all models)

To prevent sediment from entering the Zip HydroTap at connection, flush water through the supply thoroughly before connection to the HydroTap.

Open the access door and check that the filter is in place and secure.

Connect water supply to undersink unit using flexible hose already attached.

Step E - Testing and commissioning

Check that all installation steps have been carried out correctly

Locate the red fill switch on the upper left-hand side of the undersink unit and check that it is in the Fill (Up) position.

Connect the undersink unit to the power and turn the power and water on. Check that the tap-head lamps operate according to the model as follows:

Models ABC and ABB: All three lamps on

Model ABA: Lamps 1 and 3 on, lamp 2 off

Model B: Lamps 1 and 2 on, lamp 3 off

The boiling water tank is now filling and after a short time, water will start to flow from the tap. Allow the water to flow for five minutes to charge the filter and ensure clean clear water. Allow sufficient water to flow through the filter to clear the water of carbon fines.

Set the Fill switch to the On (down) position. The water will stop flowing.

For Model ABC, press and hold the blue button for about 1 minute after water begins to flow.

Check that the lamps operate according to the model as follows:

Model ABC: Lamps 1 and 2 flash once per second and lamp 3 flashes once per minute

Model ABA: Lamp 1 flashes once per second, and lamp 3 flashes once per minute.

Model ABB: Lamp 1 flashes once per second, lamp 2 stays on, and lamp 3 flashes once per minute.

Model B: Lamp 1 flashes once per second and lamp 2 stays on.

Check all connections for water leaks, rectify as necessary.

Write the date on the filter cartridge (all models except model B).

After approximately 15 minutes, lamps which were flashing (lamps 1 and/or 2) will stop flashing and stay on to indicate that the water has reached the correct temperature. Lamp 3 will continue to flash once per minute.

Test Water delivery from the tap checking for appropriate temperatures.

Use cable clips to tidy and secure wiring.

If required for Model ABC, set up the energy saver timer as detailed on page 13.

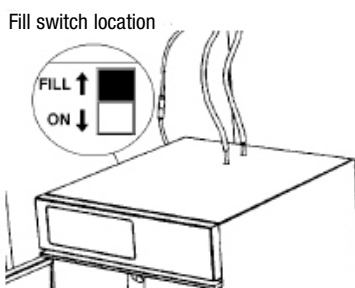

Tap head lamps

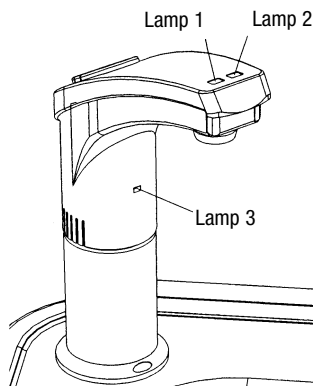

Chilled (Model ABC) or ambient (Model ABA) water button

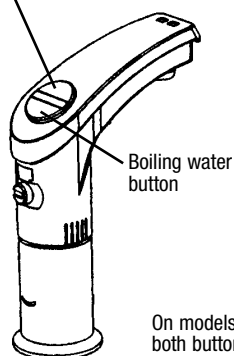

On models ABB and B both buttons dispense boiling water

Solving general problems

Symptom	Possible Cause	Solution
The filter lamp is flashing once per sec	The filter is outside its usable time (not model B)	Change the filter
The water flow is slow	The filter is blocked. (not model B) There is a problem with the water supply pressure Isolating valve not fully open	Change the filter Ask you Zip service provider to test the water pressure
The unit is not dispensing water and all the lamps are off	The power is off The timer is in power save mode (off) (model ABC only) The tap is not connected properly to the undersink unit The safety shutdown is activated (tray flooded) and the red lamp is faulty (not model B)	Check the power supply Check the timer settings Call your Zip service provider Turn off the power and the water and call your Zip service provider
The boiling water is not hot and the red lamp is flashing	The unit is being used in excess of its rated capacity	Change your usage pattern or upgrade to a larger unit
Boiling water or steam is coming from tap vent	The unit is being used in short bursts too often	Dispense boiling water for two minutes to drain. Dispense no less than one up at a time
The red lamp is flashing three times a second	There is a problem with the undersink unit	Turn off the power and the water and call your Zip Service provider
The red lamp flashes once a second when the water is hot	There is a problem with the undersink unit	Turn off the power and the water and call your Zip service provider
The boiling water is running continuously	The Fill switch is in the wrong position (Up)	Move the Fill switch on the left o side of the unit to the down position
The boiling water is not dispensing and the red lamp is on	The Tap safety lock is set There is no water supply The filter is blocked. (not model B) There is a problem with the undersink unit	Check the setting of the Tap lock Check the water supply Change the filter Turn off the power and the water and call your Zip service provider

Solving problems with the chilled water (Model ABC only)

Symptom	Possible Cause	Solution
The chilled water is not cold and the blue lamp is flashing	The unit is being used in excess of its rated capacity	Change your usage pattern or upgrade to a larger unit
Chilled water is coming from the tap vent	The unit is being used in short bursts too often	Dispense chilled water for two minutes to drain. Dispense no less than one cup at a time
The blue light is flashing three times a second	There is a serious problem with the undersink unit	Turn off the power and the water and call your Zip service provider
The chilled water is not dispensing and the blue lamp is on	There is no water supply The filter is blocked There is a problem with the undersink unit	Check the water supply Change the filter Turn off the power and the water and call your Zip service Provider

Operating the Tap

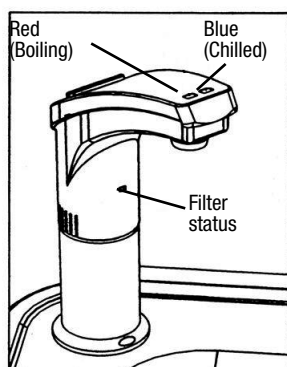

Dispensing Boiling Water with Child lock deactivated.

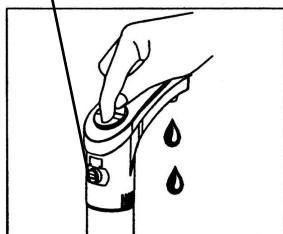

Dispensing Chilled Water

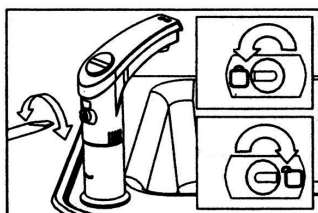
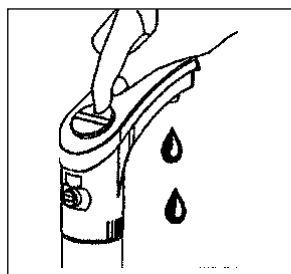

Dispensing Boiling Water with Child proof lock active



Blue Chilled Water Light

On all the time:

This indicates that the chilled water is within the usable temperature range.

Flashing slowly (once every second):

This indicates that the chilled water is not at temperature. Wait up to 30 minutes. When the chilled water is ready, the light will stop flashing. Note: The Zip HydroTap is designed to dispense chilled water in the temperature range 5°C to 10°C. During heavy usage, the temperature can rise out of this range.

Flashing rapidly (three times a second):

This indicates that there is a fault in the undersink chilling system. Call a Zip service provider.

Red Boiling Water Light

On all the time:

This indicates that the boiling water is ready.

Flashing slowly (once every second):

This indicates that the boiling water is not at required temperature. Wait up to 15 minutes. When the boiling water is ready, the light will stop flashing.

Flashing rapidly (three times a second):

This indicates that there is a leak in the undersink water system and the unit will be shut down. In this case call Zip services.

Filter Change Light Flashing slowly (once every minute):

The light will flash once every minute when the filter is within its specified lifespan.

Flashing rapidly (once per second):

The light will flash once per second when the filter is due for replacement. Refer to section 3, "Replacing the filter".

Boiling Water Button

Press and hold down to pour boiling water.

Chilled Water Button

Press and hold down to pour chilled water.

Child Proof Lock

The child proof lock can be activated to prevent boiling water flowing if the hot button is inadvertently pushed.

To turn on, rotate the red button to the locked position.

To turn off, rotate the red button to the unlocked position.

To operate the tap when the child proof lock is activated, press and hold the child proof lock button in and then press the hot water button.

Note: Whilst the Zip HydroTap is designed to dispense water within 2°C to 6°C of boiling point. The temperature can drop out of this range during heavy usage.

Cleaning

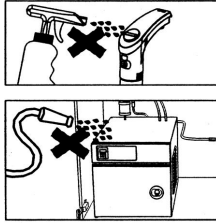

Do not use strong, corrosive, spray or abrasive cleaners. Clean with a soft cloth or brush and mild soap and water.

Do not spray water over the tap as it may damage the low-voltage electronics.

Undersink units must never be cleaned with water jets.

Replacing the Filter

The Zip HydroTap timer is set to remind you to replace your filter every 9 months. When a filter change is due, the Change Filter light will come on and remain on until reset.

Depending on local water quality conditions and usage, the filter may require changing every 6 to 12 months. You may also need to replace the filter if you notice unpleasant odours or tastes, or if the flow rate of the tap is slow.

Some water may drip from the filter head (socket) during replacement. Keep a bucket and towel handy to catch drips and mop up any spills.

1. Locate service valve in the water supply line and turn off the water supply.
2. Grasp filter cartridge and twist right to left one quarter turn until it stops.
3. Ease cartridge downwards to detach it from the filter head (socket).
4. Do not tilt the cartridge as dirty water may spill from it if tilted.
5. Unpack replacement cartridge and write today's date where shown on the label.
6. Avoid bacterially contaminating cartridge top whilst inserting into head.
7. Align cartridge tabs with the slots on the under-side of the filter head.
8. Slide cartridge upward into head and rotate left to right until it stops.
9. Open the service valve and check filter head for leaks. Refit if leaking.
10. To purge air from filter follow purging procedure described below.
11. Wipe up any spills and dispose of spent filter cartridge and packaging thoughtfully.
12. Run the hot or cold water through the tap continuously for 5 minutes.
13. Reset filter status, by pushing the red button positioned to the left of the cartridge.

Note: Freshly installed filters may cause water to appear milky. The water should clear after running a few litres of water through the filter.

Number of users per Zip HydroTap	10	50	100
Estimated weekly consumption (litres)	50	250	500
Filter change - sub-micron (weeks)	52	22	11

- Warning: If the Zip HydroTap is switched off for a long period of time (one weekend plus), run water through the chilled water outlet for at least 5 minutes before consumption.

Setting the Energy Saver Timer

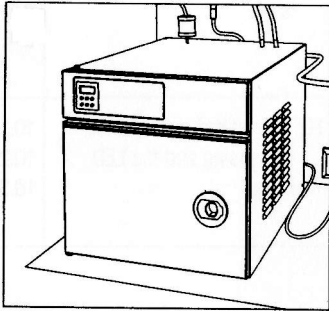

If you do NOT wish to programme the timer to turn the Zip HydroTap on and off daily, you may ignore the following instructions.

The Zip HydroTap will operate continuously if you do not programme the timer at all.

If you do wish to programme the timer to turn the Zip HydroTap on and off daily, first set the timer to the correct time, then follow the instructions set out below. You can programme the timer to turn the Zip HydroTap on and off up to 3 times daily.

Setting Correct Time

Hold down the  button until the following 3 steps are completed.

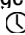
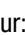
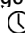
1. Change day:
With  button held down, press button "d".
A triangle points to day currently selected.
Days are marked 1 to 7.
Day 1 = Monday, Day 7 = Sunday.
Press and release button "d" until correct day is selected.
2. Change hour:
With  button held down, press button "h".
Screen shows hour currently selected.
Clock works on 24 hour time: 1 = 1 am, 13 = 1 pm.
Press and release button "h" until correct hour is selected.
3. Change minute:
With  button held down, press button "m".
Screen shows minute currently selected.
Press and release button "m" until correct minute is selected.



When, day, hour and minute are correct, release  button.

Programming Power ON & OFF

1. Press and release the "Prog" button once.
2. Display will show first setting: (—:— 1 ON).
3. Triangle over "1" indicates setting for Monday.
4. Press and release "h" and "m" buttons to set ON time.
5. Press and release the "Prog" button once.
6. Display will show second setting: (—:— OFF).
7. Triangle over "1" indicates setting for Monday.
8. Press and release "h" and "m" buttons to set OFF time.
9. Press and release "Prog" button once.

Repeat procedure to set further Monday ON and OFF times.
Or press and release "d" to go directly to first setting next day.
Programme ON and OFF for each day of week.
When complete, press and release  button.

During programming a 40 second delay will return you to clock display.
To return to programming point, press "Prog" and "d" buttons together.

To review programme, press and release "Prog" repeatedly.
To erase any ON or OFF setting displayed, press "h" and "m" together.
For total reset, press "d", , "m" and  buttons together.

To over-ride OFF setting, press and release  button – will remain ON until the next programmed OFF time.

To lock timer ON or OFF press "m" and  buttons together. Check screen: black dot over ON or OFF indicates timer locked.

Warranty

The Zip appliance you have chosen is precision-built from the finest materials available and should give many years of trouble free service.

Certain warranties may be implied by law into your contract with Zip. The warranty provided below is additional to these implied warranties and nothing set out below shall limit your statutory rights or rights at law.

Zip Heaters (UK) Pty Ltd warrants that, should any part fail within 12 calendar months of installation, that part will be repaired or replaced free of charge by Zip or its Distributor or Service Provider, except as set out below, provided the appliance is installed and used strictly in accordance with the instructions supplied, and that failure is not due to accident, misuse, abuse, unsuitable water conditions, or to any alteration, modification or repair by any party not expressly nominated by Zip.

No costs are payable by the customer other than any mileage or travelling-time charges incurred by a Zip Service Provider or the cost of removal, cartage and re-installation of any component of the appliance if it needs to be returned for repair to Zip or its Distributor.

This warranty does not cover damage resulting from non-operation of the appliance or consequential damage to any other goods, furnishings or property.

No warranty applies to the life of any filtration cartridge installed with the appliance as cartridge life may vary according to water quality and the rate of water consumption.

Zip does not exclude, restrict or modify any liability that cannot be excluded, restricted or modified or which cannot, except to a limited extent, be excluded, restricted or modified as between the owner or user and Zip under the laws applicable.

Furthermore, this warranty does not displace any statutory warranty, but, to the extent to which Zip is entitled to do so, the liability of Zip under any statutory warranty will be limited at Zip's option to the replacement of the appliance or supply of equivalent appliance, the payment of the cost of replacing the appliance or acquiring an equivalent appliance, or the payment of the cost of having the appliance repaired or the repair of the appliance.

Registering Your Purchase

Registering your Zip installation on the Zip website may help to establish date of installation should it become necessary to service the appliance under terms of the Zip warranty. To register your installation go to www.zipheaters.co.uk and look under the heading "Warranty".

Contact Details



Instant Boiling Water

Zip Heaters (UK) Ltd
14/15 Bertie Ward Way
Rash's Green Dereham
Norfolk NR19 1TE

www.zipheaters.co.uk
Telephone: 0870 608 8888
Facsimile: 01362 692448

The standard cup referred to in this publication is 167 ml (6 fl oz).

The standard glass is 200 ml (7 fl oz).

The terms "Zip", "HydroTap" and "Hydroboil" are registered trade marks.

Zip products described in this publication are manufactured under one or more of the following patents: AU675601, AU637412, AU635979, GB0422305, GB2065848, US4354049, US5103859, and US5099825. Other patents are in force and patent applications are pending.