

Contents

Description	2
Warranty	2
Warnings	3
Specification	4
Spare Parts	4
Installation	5-6
Operation	6-7
Maintenance	7-8

Description

Zip Chilltower is designed to supply both chilled water at 10°C and cold water at ambient temperature at the touch of a tap.

Zip Chilltower continues to operate automatically refilling and cooling as necessary and is supplied complete with a five micron fully encapsulated double action carbon filter.

Zip Chilltower complies with LVD and EMC directives and is CE endorsed.

Warranty

Your Zip Chilltower is precision built from the finest materials available and should give you many years of trouble-free service.

Zip Heaters (UK) Ltd warrants that should any part of the Chilltower fail within one (1) calendar year of installation, that part will be replaced or repaired by Zip Heaters (UK) Ltd free of charge, except as set out below, provided that the failure is not due to accident, misuse, abuse, condition of the water or failure to follow installation instructions or service requirements.

The only charges payable by the customer are the cost of removal, re-installation and cartage, should any component need to be returned for repair.

This warranty does not cover damage resulting from non-operation or consequential damage to any goods, furnishings or property.

Zip Heaters (UK) Ltd's liability will be limited to replacement or repair at the option of Zip Heaters (UK) Ltd.

This warranty does not displace any statutory warranty in relation to the Chilltower.

Warnings

This unit is designed for direct connection to a potable water supply with a maximum supply pressure of 50 psi and a minimum supply pressure of 20 psi. Where the water pressure exceeds the maximum rating, a pressure reducing valve set to 50 psi is required to safeguard against abnormal pressure. The pressure reducing valve is not supplied with the Chilltower. **Note: The supply pressure can increase significantly at times of low demand.**

Water temperature control is automatic and has been factory set to provide drinking water at an optimum temperature of 10°C. **Tampering in any way shall void the warranty.**

Flush the system for 5 minutes after a period on non-use exceeding 2 days.

Filters must be changed at the recommended intervals – see 'Filter Replacement'. Failure to do so may cause the water to become biologically unsafe. Only Zip filters to match those supplied with the chiller should be used. The Zip Chilltower filters will remove solids and enhance the taste of the water but cannot be used to purify or cleanse unpotable water.

Do not use the Chilltower if it is suspected of being frozen. Switch off the electrical supply if the water ceases to flow and **do not** switch on again until a competent person has checked that it is safe to do so.

The Zip Chilltower is designed for connection to the mains water supply using flexible, plastic tubing. Any breach in the supply pipework or fittings will result in potentially serious water damage to the surroundings. Zip Heaters (UK) Ltd accepts no liability for such damage and it is the responsibility of the owner to take all necessary measures to avoid and contain any leakage from the unit, its supply pipe work and fittings.

The owner is responsible for all maintenance and repair of the product after installation and Zip Heaters (UK) Ltd can accept no liability for any indirect or consequential loss or damage, costs, expenses or other claims for consequential compensation whatsoever which might arise out of or in connection with the provision of this product.

IMPORTANT. The cold water mains supply should be fitted with a WRAS approved isolating valve to aid servicing. Electrical installation must be in accordance with the current edition of the IEE wiring regulations.

THIS APPLIANCE MUST BE EARTHED.

Specification

Delivery Temperature	10°C
Recovery rating	45 glasses per hour (see note)
Nominal rating	0.17 kW / 240V
Minimum supply pressure	20 psi (1.5 bar)
Maximum supply pressure	50 psi (3.5 bar)
Dimensions (H x W x D)	950 x 300 x 380
Net weight:	13 kg

Note: Standard glass 200ml. Rating shown represents the number of glasses that may be drawn at the specified temperature of 10°C. Actual outlet temperature may vary as a result of variations in water inlet temperature and ambient air temperature.

Spare Parts

Item	Description
1	Lid
2	Float valve assembly
3	White tap
4	Blue tap
5	Tap washer
6	Drip tray
7	Thermostat
8	Compressor

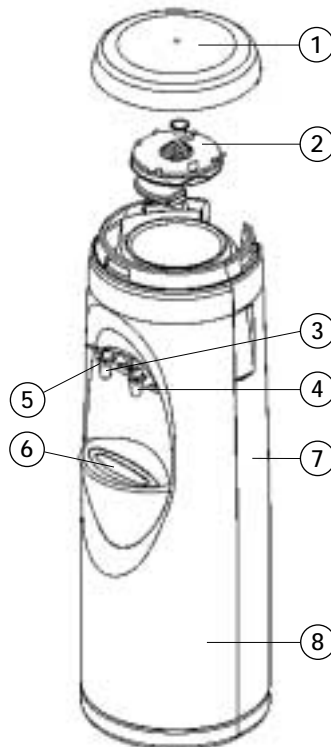

Installation

These instructions must be read and fully understood before commencing the installation. If in doubt, or in need of further guidance please contact Zip on 0870 608 8888.

Positioning the unit

- The chiller and filtration system are indoor units and must not be exposed to the elements of nature.
- DO NOT install in a location where the unit or the incoming water supply may freeze.
- DO NOT locate near hot air vents, radiant heaters, boilers or in direct sunlight.
- Place the unit on a level floor and in a location where it will not be subject to accidental impact.
- Leave at least a 30mm clearance around the unit to ensure proper ventilation.
- Water pressure should be between 20 psi and 50 psi.
- Sufficient space behind the unit should be allowed for the filter assembly.

Installing the unit

- The plumbing installation must be done in accordance with local Water Council regulations and these installation instructions by a competent installer who is responsible for supplying and installing all valves as are required by local regulations and relevant standards.
- The cold water mains supply should be fitted with a WRAS approved isolating valve (not supplied) to aid servicing.
- A single check valve and strainer (not supplied) must be fitted in the supply pipe work between the isolating valve and the chiller.
- If the supply pressure exceeds 50 psi a pressure reducing valve set to 50 psi must be fitted.

CAUTION: Flush the supply line thoroughly before connection to ensure the removal of all foreign matter and to avoid blocking the float valve mechanism and filter.

1. Fit the filter head to the filter bracket using the 4 screws provided
2. Loosen the Phillips head screws on the handle at the rear of the Chiller unit to enable the key-hole slots on the filter bracket to be located and re-tighten.
3. Remove the lid from the chiller.
4. Remove the float valve assembly from the bowl.
5. Remove the transit packaging from the float valve assembly.
6. Connect the cold water supply to the filter head using 1/4" nylon tubing to the shut off valve supplied.
7. Flush the filter thoroughly for at least 5 minutes to remove any loose carbon particles that could impede operation of the float valve mechanism.
8. Connect the filter head to the push fit connection on the float valve assembly using 1/4" nylon tubing and the elbow fitting supplied.
9. To prime the valve, hold it over the bowl and allow water to fill the bowl to the level of the stratifier plate
10. Place the float valve assembly into the bowl and allow the water to find its own level. This is indicated by the absence of water flow noise.
11. Draw off some water via the tap and confirm that the bowl is re-filling by listening for the sound of water flow noise.
12. Replace the chiller lid.
13. If it is required to use the drain facility first open the centre hole on the drip tray drain point with a 3mm drill then connect the drain tube to a suitable drainage facility.
14. Check all plumbing for leaks before connecting the unit to the power supply using the plug and lead supplied.

Note: 1/4" nylon tubing is not supplied with the unit.

Operation

Chilled water or ambient temperature water is obtained by pressing the lever on the blue and white taps respectively.

The water is chilled by a refrigeration unit fitted within the chiller.

The float valve mechanism is designed so that a primary float maintains a constant water level in the cold bowl of the cooler. If this float should fail to stop

the incoming water due to wear or foreign material being lodged on the seal, an emergency float will operate to shut off the incoming water.

Flush the system for 5 minutes after a period on non-use exceeding 2 days.

Do not use the chiller if it is suspected of being frozen. Switch off the electrical supply if the water ceases to flow and **do not** switch on again until a competent person has checked that it is safe to do so.

Maintenance

Cleaning

Never use strong, corrosive or abrasive cleaning materials on the Zip Chilltower.

Wipe clean the outer surfaces with a sponge or a soft cloth using a mild soap and water.

Filter replacement

CAUTION: Not changing filter cartridges when required may cause the water to become biologically unsafe.

For safe operation, the filter cartridges should be replaced at least every 6 months or earlier if you notice a reduced flow rate or an unpleasant taste or odour in the water. **Filter life is not covered by warranty.**

The filter must be fitted in accordance with local Water Authority Regulations and only Zip filters to match those supplied with the chiller should be used. Replacement filter cartridges can be obtained through Zip distributors or direct from Zip.

DO NOT use filter where water is microbiologically unsafe or with water of unknown quality.

Before attempting to remove the filter cartridges:

1. Turn the power supply off.
2. Close the shut off valve to turn off the water supply.

Twist the filter cartridge $\frac{1}{4}$ turn anti-clockwise so that the tabs of the cartridge disengage from the filter head and firmly pull the cartridge downward to remove. It may be necessary to slightly twist the cartridge from side to side. A small amount of water may be discharged.

Lubricate the 'O' ring seals of the new cartridge with food grade silicone lubricant or water.

Line up the new cartridge tabs, push the cartridge fully into the filter head and twist $\frac{1}{4}$ turn clockwise until it locks into place.

Disconnect the pipe from the filter head to the float valve assembly and open the shut off valve to flush the filter thoroughly for at least 5 minutes to remove any loose carbon particles that could impede operation of the float valve mechanism.

Close the shut off valve and reconnect the filter head to the float valve assembly.

Open the shut off valve and check for leaks.

Re-connect the power supply to the unit.

Servicing

The entire refrigeration system is hermetically sealed. Contact Zip for advice should the system fail to operate.

No lubrication of any kind is required on the chiller.

All service work should be performed by an authorised Zip service engineer. If your Zip chiller requires maintenance, the Zip service team are available to help with a comprehensive range of spare parts and assistance.

Contact Zip for details of their planned maintenance services including filter replacement, sanitising and full breakdown cover.

Zip recommends that the following are checked prior to calling for service:

1. Normal water supply is available and is at an adequate pressure. Try the normal cold water tap at the sink.
2. If flow is blocked, check that the filters have not passed their recommended use-by date. The installation date should be written on the filter cartridges.
3. Normal power is available to the chiller unit. The chiller is connected and switched on.

When calling for service, please always specify the appliance model and serial number. Use this chart to record the number during installation.

Model No.	Serial No.	Date of installation

Zip Heaters (UK) Ltd. Dereham, Norfolk NR19 1TE
Telephone 0870 608 8888 Telefax 01362 692448
www.zipheaters.co.uk